

I korruse plaan
1:200

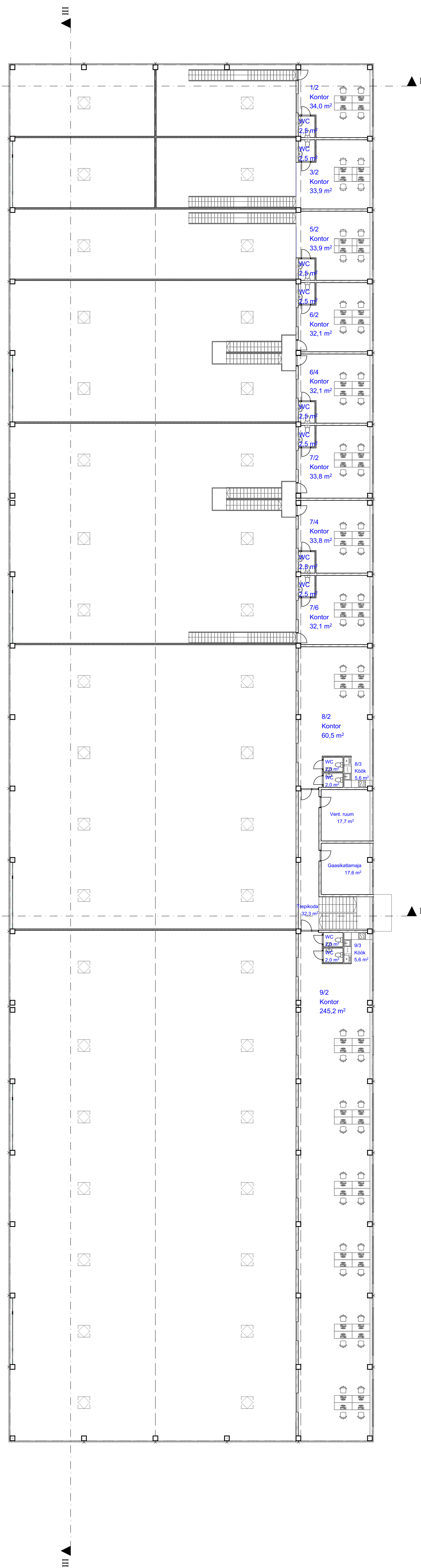

II korruse plaan
1:200

| Ruumide eksplikatsioon | | |
|--------------------------|---------------|-----------------------|
| # | Ruumi nimetus | Pindala |
| Rendipind 1 | | |
| 1/1 | Laopind | 109,1 |
| 1/2 | Kontor | 34,0 |
| 1/3 | WC | 2,5 |
| | | 145,6 m ² |
| Rendipind 2 | | |
| 2/1 | Laopind | 72,5 |
| | | 72,5 m ² |
| Rendipind 3 | | |
| 3/1 | Laopind | 106,2 |
| 3/2 | Kontor | 33,9 |
| 3/3 | WC | 2,5 |
| | | 142,6 m ² |
| Rendipind 4 | | |
| 4/1 | Laopind | 71,3 |
| | | 71,3 m ² |
| Rendipind 5 | | |
| 5/1 | Laopind | 178,2 |
| 5/2 | Kontor | 33,9 |
| 5/3 | WC | 2,5 |
| | | 214,6 m ² |
| Rendipind 6 | | |
| 6/1 | Laopind | 359,3 |
| 6/2 | Kontor | 32,1 |
| 6/3 | Kontor | 2,5 |
| 6/4 | Kontor | 32,1 |
| 6/5 | WC | 2,5 |
| | | 428,5 m ² |
| Rendipind 7 | | |
| 7/1 | Laopind | 558,0 |
| 7/2 | Kontor | 33,8 |
| 7/3 | WC | 2,5 |
| 7/4 | Kontor | 33,8 |
| 7/5 | WC | 2,5 |
| 7/6 | Kontor | 32,1 |
| 7/7 | WC | 2,5 |
| | | 665,2 m ² |
| Rendipind 8 | | |
| 8/1 | Laopind | 701,9 |
| 8/2 | Kontor | 60,5 |
| 8/3 | Köök | 5,6 |
| 8/4 | WC | 2,0 |
| 8/5 | WC | 2,0 |
| | | 772,0 m ² |
| Rendipind 9 | | |
| 9/1 | Laopind | 1292,6 |
| 9/2 | Kontor | 245,2 |
| 9/3 | Köök | 5,6 |
| 9/4 | WC | 2,0 |
| 9/5 | WC | 2,0 |
| | | 1547,4 m ² |
| Tehnopind | | |
| Gaasikattlamaja | | 17,6 |
| Vent. ruum | | 17,7 |
| | | 35,3 m ² |
| Üldkasutatav pind | | |
| Trepikoda | | 17,4 |
| Trepikoda | | 32,3 |
| | | 49,7 m ² |
| | | 4144,7 m ² |